

MaxGard® Interconnection Systems

200 Amp Standard Service

** If receptacle is desired with a Straight Adapter instead of standard Angle Adapter, substitute "S" for the "A" in the catalog number of the Receptacle with Angle Adapter or Adapter and Box.

† Standard cable bushings shown; see **page 34** for other sizes available at no extra cost if specified on order.

†† Always furnished with screw collar. We recommend cup cap with male plug; order catalog number DS2CC.

Maximum lug wire 4/0 AWG 19-strand or flexible, cable entrance .625" diameter.

Receptacles furnished with flap cap also have screw thread to accept male collar on plug.

Catalog numbers shown are for flap cap receptacles; change "DF" to "DS" for ordering screw cap.

Boldface figures are for voltage assignment. For different ratings, see **page 40**.

Outlet furnished at location "B" unless otherwise specified. 3" NPT.

▼ **Control contacts for plug/receptacles:**
Use "K" where noted. Ex: **DS2104MP00K**

For Adapters, Junction Boxes and Accessories, see **pages 34-37**.

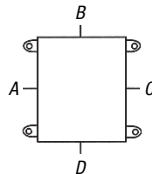

Male Plug††

Female Connector

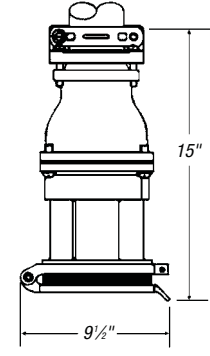
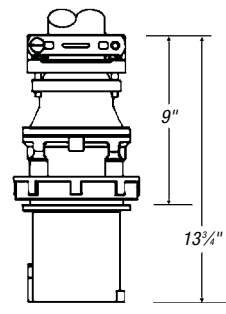

Device Ratings and Polarizations

Maximum 600VAC or 250VDC

(For full polarization, see **page 40**)

POLE	WIRE	CONDUCTOR PLACEMENT	VOLTAGE 60 HZ	CAT. NO.	STANDARD BUSHING I.D.†	CAT. NO.	STANDARD BUSHING I.D.†
2	3		277	DS2104MP000	2 1/8"	DF2104FP000	2 1/8"
			125	DS2107MP000		DF2107FP000	
2	3		480	DS2204MP000	2 1/8"	DF2204FP000	2 1/8"
			250	DS2207MP000		DF2207FP000	
			600	DS2214MP000		DF2214FP000	
			208	DS2216MP000		DF2216FP000	
3	4		277/480	DS2304MP000	2 1/4"	DF2304FP000	2 1/4"
			125/250	DS2307MP000		DF2307FP000	
			120/208	DS2316MP000		DF2316FP000	
3	4		3Ø 480	DS2404MP000	2 1/4"	DF2404FP000	2 1/4"
			3Ø 250	DS2407MP000		DF2407FP000	
			3Ø 600	DS2414MP000		DF2414FP000	
			3Ø 208	DS2416MP000		DF2416FP000	
			3Ø 440	DS2421MP000		DF2421FP000	
4	5		3ØY 277/480	DS2504MP000	2 1/2"	DF2504FP000	2 1/2"
			3ØY 347/600	DS2514MP000		DF2514FP000	
			3ØY 110/208	DS2516MP000		DF2516FP000	
			3ØY 250/440	DS2521MP000		DF2521FP000	

MaxGard® Interconnection Systems



Female Receptacle with Angle Adapter** and Junction Box



Female Receptacle with Angle Adapter**



Female Receptacle

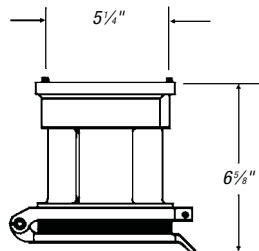
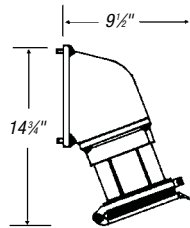
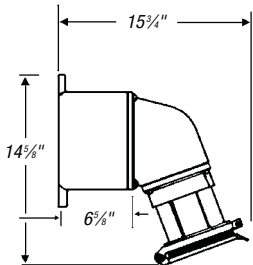

CAT. NO.	CAT. NO.	CAT. NO.
DF2104FRAB0	DF2104FRA00	DF2104FR000
DF2107FRAB0	DF2107FRA00	DF2107FR000
DF2204FRAB0	DF2204FRA00	DF2204FR000
DF2207FRAB0	DF2207FRA00	DF2207FR000
DF2214FRAB0	DF2214FRA00	DF2214FR000
DF2216FRAB0	DF2216FRA00	DF2216FR000
DF2304FRAB0	DF2304FRA00	DF2304FR000
DF2307FRAB0	DF2307FRA00	DF2307FR000
DF2316FRAB0	DF2316FRA00	DF2316FR000
DF2404FRAB0	DF2404FRA00	DF2404FR000
DF2407FRAB0	DF2407FRA00	DF2407FR000
DF2414FRAB0	DF2414FRA00	DF2414FR000
DF2416FRAB0	DF2416FRA00	DF2416FR000
DF2421FRAB0	DF2421FRA00	DF2421FR000
DF2504FRAB0	DF2504FRA00	DF2504FR000
DF2514FRAB0	DF2514FRA00	DF2514FR000
DF2516FRAB0	DF2516FRA00	DF2516FR000
DF2521FRAB0	DF2521FRA00	DF2521FR000

Staten Island Ferry

SOLUTION 200 Amp

200A MaxGard® connections on ferry deck



200A MaxGard® inlets with disconnects



30A and 200A MaxGard® interlocks



200A MaxGard® interlocks in parallel

Russellstoll® Pin and Sleeve Power Connectors